

## Network Camera Firmware Version: V5.7.0

### Release Note

(2022-03-14)

<b>Firmware Basic Information</b>	Firmware Version:	V5.7.0 build220308
---------------------------------------	-------------------	--------------------

### 2x23G2, 2x26G2 Camera V5.7.0 Features

#### 1. New Features

- New overseas 2X26, 2X23 series;
- Added support for metadata, substream overlay does not support target box;

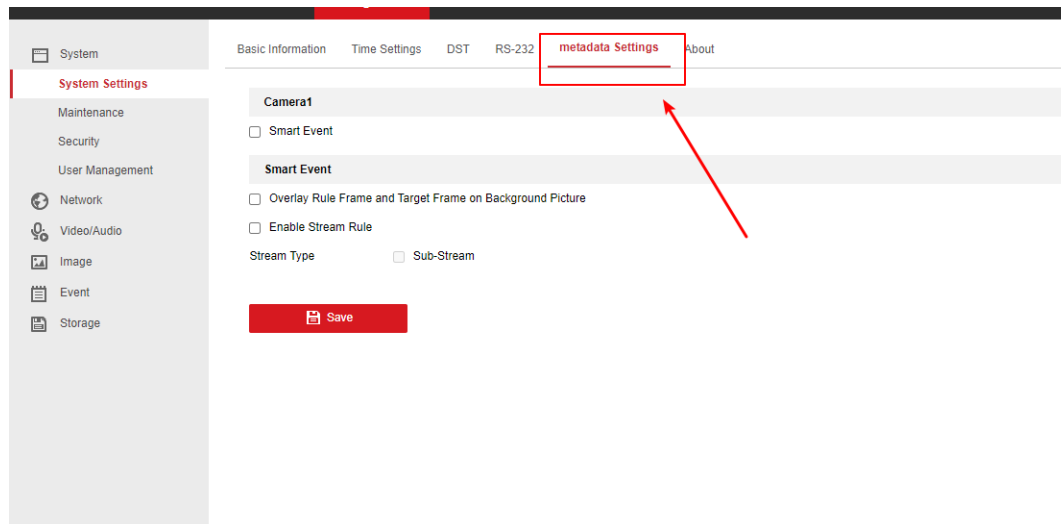

- Added support HPC;
- Added Korean and Hebrew to the OSD function for overseas products;

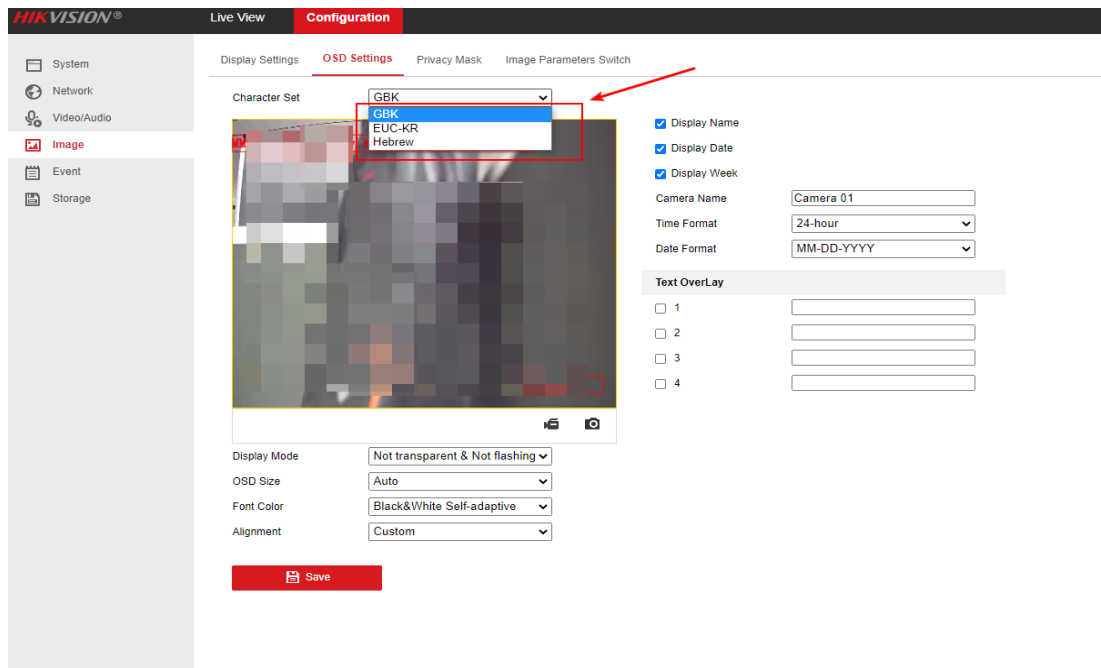

- The manual triggering of Light and Audible alarm on HC is not affected by the Arming Schedule on the device;

## 2. Improved Features

- Channel IPC's face exposure function in face capture is closed by default;

## Customer Impact and Recommended Action

This update refers to function/compatibility improvement and will take effect automatically after the Date of Change. We are very sorry for any inconvenience of use-habit changes caused by this action. For any questions and request for this firmware, please contact our local technical support team.

### Remarks:

- Hikvision reserves the right to change, alter or withdraw the above notification without prior notice.
- Product design and specifications are subject to change without prior notice.
- The Hikvision firmware may contain errors known as errata which may cause the product to deviate from published specifications. Current characterized errata are available on request.
- Hikvision is not liable for any typing or printing errors.

Hikvision Digital Technology CO., Ltd.  
No. 555 Qianmo Road, Binjiang District, Hangzhou  
310051, China  
Tel: +86-571-8807-5998

<b>Supported Product List (2x23G2, 2x26G2 Series)</b>	
<b>Product Category</b>	<b>Model Number</b>
EasyIP 2.0 Plus with AcuSense	DS-2CD2023G2-I
EasyIP 2.0 Plus with AcuSense	DS-2CD2023G2-IU
EasyIP 4.0 with AcuSense	DS-2CD2026G2-I
EasyIP 4.0 with AcuSense	DS-2CD2026G2-IU
EasyIP 4.0 with AcuSense	DS-2CD2026G2-IU/SL
EasyIP 2.0 Plus with AcuSense	DS-2CD2123G2-I
EasyIP 2.0 Plus with AcuSense	DS-2CD2123G2-IS
EasyIP 2.0 Plus with AcuSense	DS-2CD2123G2-IU
EasyIP 4.0 with AcuSense	DS-2CD2126G2-I
EasyIP 4.0 with AcuSense	DS-2CD2126G2-ISU
EasyIP 2.0 Plus with AcuSense	DS-2CD2323G2-I
EasyIP 2.0 Plus with AcuSense	DS-2CD2323G2-IU
EasyIP 4.0 with AcuSense	DS-2CD2326G2-I
EasyIP 4.0 with AcuSense	DS-2CD2326G2-ISU/SL
EasyIP 4.0 with AcuSense	DS-2CD2326G2-IU
EasyIP 2.0 Plus with AcuSense	DS-2CD2523G2-I
EasyIP 2.0 Plus with AcuSense	DS-2CD2523G2-IS
EasyIP 4.0 with AcuSense	DS-2CD2526G2-I
EasyIP 4.0 with AcuSense	DS-2CD2526G2-IS
EasyIP 2.0 Plus with AcuSense	DS-2CD2623G2-IZS
EasyIP 4.0 with AcuSense	DS-2CD2626G2-IZSU/SL
EasyIP 4.0 with AcuSense	DS-2CD2626G2-IZS
EasyIP 4.0 with AcuSense	DS-2CD2626G2T-IZS

EasyIP 2.0 Plus with AcuSense	DS-2CD2723G2-IZS
EasyIP 4.0 with AcuSense	DS-2CD2726G2-IZS
EasyIP 4.0 with AcuSense	DS-2CD2726G2T-IZS
EasyIP 2.0 Plus with AcuSense	DS-2CD2T23G2-2I
EasyIP 2.0 Plus with AcuSense	DS-2CD2T23G2-4I
EasyIP 4.0 with AcuSense	DS-2CD2T26G2-2I
EasyIP 4.0 with AcuSense	DS-2CD2T26G2-4I
EasyIP 4.0 with AcuSense	DS-2CD2T26G2-ISU/SL

*Note: Models in red font are newly released models.*